



Ocean Reef

RESORT

sales & marketing by:

thehoffmangroup
OCEANFRONT PROPERTY SPECIALISTS

toll free: 800-458-7890

local: 843-692-3333

www.oceaninvestments.com

OCEAN REEF NORTH TOWER – PHASE II

New Construction Condominiums, Opened Fall 2006

Adjoined on the north end of this popular oceanfront resort, the new construction Ocean Reef North Tower Phase II complements the existing building while adding an exciting new dimension to the skyline. In fact, it not only looks like it has always been there but also provides a “u” configuration that allowed the developer to add a new swimming pool amenity featuring giant “mushroom” waterfalls that children of all ages flock to!

The architect was brilliant in designing for the best ocean exposure for the addition’s 52 units. The oceanfront four-bedroom condo with its huge wrap balcony is the only four-bedroom option in the area and is sure to be a huge draw for vacationers. The angle oceanfront two-bedroom style and one of the one-bedroom styles are “double bay” plans with private balcony off both the living room and the master bedroom. All the units are fully furnished and designer accessorized.

The combination of a prestigious northern Myrtle Beach location, prime oceanfront footage, and convenient access to the area’s restaurants, entertainment and golf courses, have brought Ocean Reef Resort a long tradition of satisfied vacationers. The resort’s extensive amenities include oceanfront pools, indoor pools, a 250’ lazy river, full-service restaurant, seasonal café, extensive meeting facilities and a gift shop. The walkway connecting the front registration area to the oceanfront restaurant is dotted with seating giving it a welcoming “Southern charm” atmosphere.

Call The Hoffman Group today to find out how you can become a proud owner in this special resort.

sales & marketing by:

thehoffmangroup
OCEANFRONT PROPERTY SPECIALISTS

toll free: 800-458-7890

local: 843-692-3333

www.oceaninvestments.com



sales & marketing by:

the hoffmann group
OCEANFRONT PROPERTY SPECIALISTS

toll free: 800-458-7890

local: 843-692-3333

www.oceaninvestments.com

All renderings, maps, landscaping, elevations, and plans are artist's conceptions. They are not to scale and are not guaranteed. The developer/builder reserves the right in its sole discretion to make changes or modifications to maps, plans, specifications, materials, features and colors without notice.

Ocean Reef

UNIT H

Oceanfront
4 Bedroom
1,728 square feet
216 balcony square feet

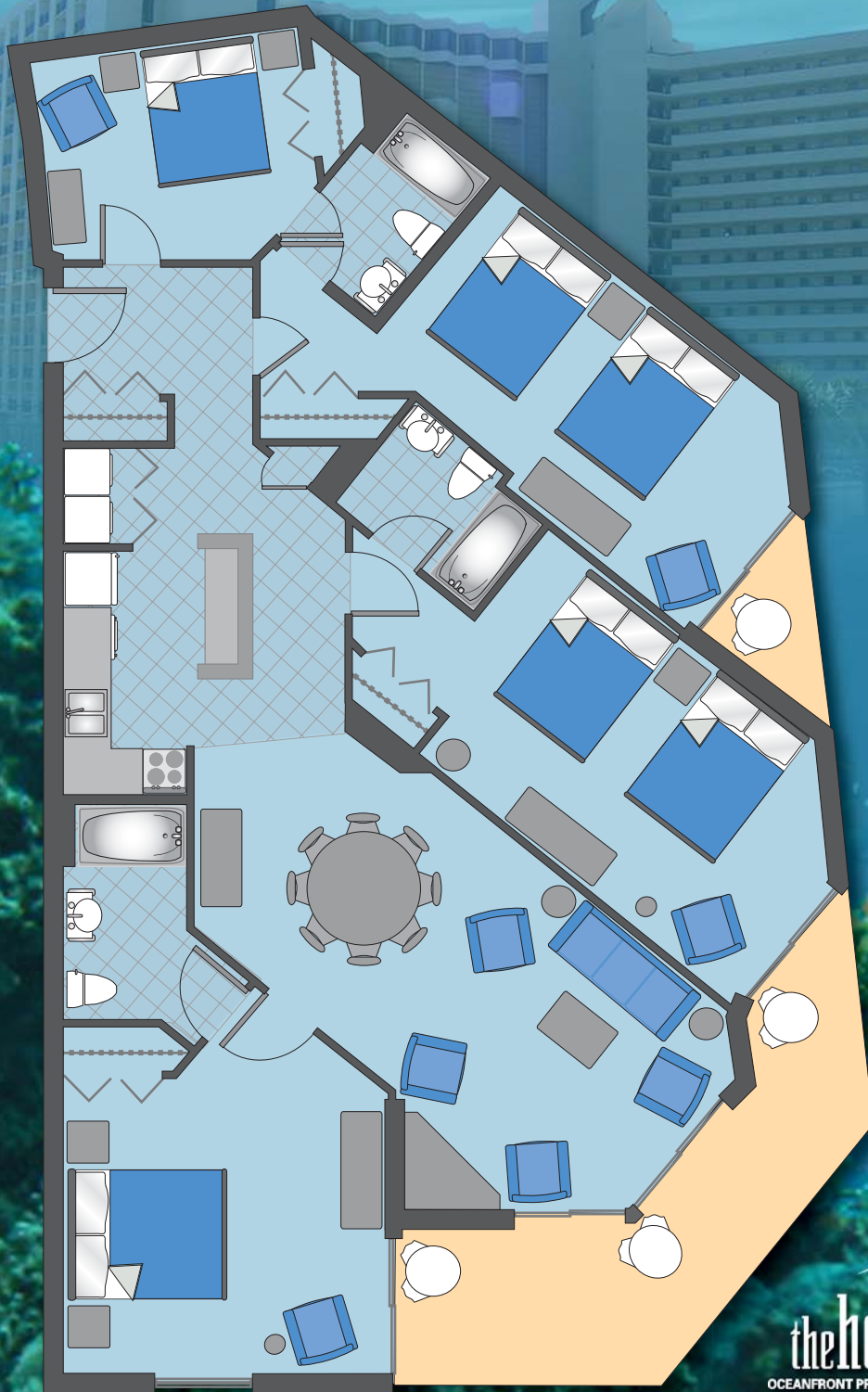

sales & marketing by:

thehoffmangroup
OCEANFRONT PROPERTY SPECIALISTS

toll free: 800-458-7890

local: 843-692-3333

www.oceaninvestments.com

All renderings, maps, landscaping, elevations, and plans are artist's conceptions. They are not to scale and are not guaranteed. The developer/builder reserves the right in its sole discretion to make changes or modifications to maps, plans, specifications, materials, features and colors without notice.

Ocean Reef

UNIT G

Angle Oceanfront
1 Bedroom
557 square feet
56 balcony square feet

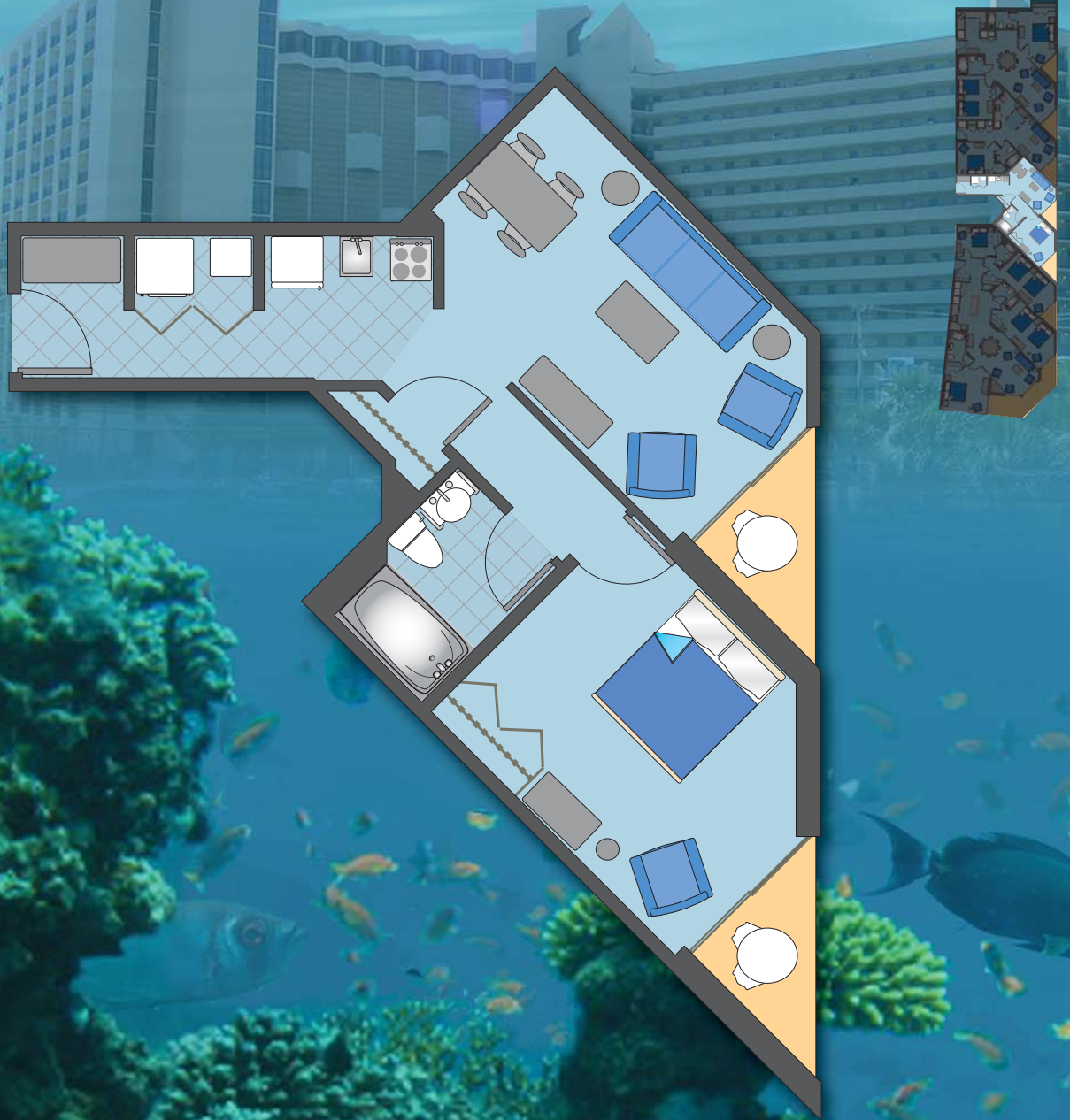

sales & marketing by:

the hoffmann group
OCEANFRONT PROPERTY SPECIALISTS

toll free: 800-458-7890

local: 843-692-3333

www.oceaninvestments.com

All renderings, maps, landscaping, elevations, and plans are artist's conceptions. They are not to scale and are not guaranteed. The developer/builder reserves the right in its sole discretion to make changes or modifications to maps, plans, specifications, materials, features and colors without notice.

Ocean Reef

UNIT F

Angle Oceanfront
1 Bedroom
610 square feet
28 balcony square feet



sales & marketing by:

thehoffmangroup
OCEANFRONT PROPERTY SPECIALISTS

toll free: 800-458-7890
local: 843-692-3333
www.oceaninvestments.com

All renderings, maps, landscaping, elevations, and plans are artist's conceptions. They are not to scale and are not guaranteed. The developer/builder reserves the right in its sole discretion to make changes or modifications to maps, plans, specifications, materials, features and colors without notice.

Ocean Reef

UNIT E

Angle Oceanfront
2 Bedroom
1,067 square feet
56 balcony square feet



sales & marketing by:

thehoffmangroup
OCEANFRONT PROPERTY SPECIALISTS

toll free: 800-458-7890

local: 843-692-3333

www.oceaninvestments.com

All renderings, maps, landscaping, elevations, and plans are artist's conceptions. They are not to scale and are not guaranteed. The developer/builder reserves the right in its sole discretion to make changes or modifications to maps, plans, specifications, materials, features and colors without notice.