



Ocean Reef

RESORT

sales & marketing by:

thehoffmangroup
OCEANFRONT PROPERTY SPECIALISTS

toll free: 800-458-7890

local: 843-390-8900

www.oceaninvestments.com

OCEAN REEF NORTH TOWER

Redevelopment Condominiums, Opened March 2005

The combination of a prestigious northern Myrtle Beach location, prime oceanfront footage, and convenient access to the area's restaurants, entertainment and golf courses, has brought the Ocean Reef Resort a long tradition of satisfied vacationers. The resort's extensive amenities include oceanfront pools, indoor pools, a 250' lazy river, full-service restaurant, seasonal café, extensive meeting facilities and a gift shop. The walkway connecting the front registration area to the oceanfront restaurant is dotted with seating giving it a welcoming "Southern charm" atmosphere. The oceanfront portion of the resort became efficiency and suite condominiums in March 2005. The new construction South Tower wing offers 1, 2, and 3 bedroom condominiums and the new construction North Tower wing offers 1, 2 and 4 bedroom condominiums.

With all three sections now completed, the resulting "u" configuration allowed the developer to build a new entrance area swimming pool amenity featuring giant "mushroom" waterfalls that children of all ages flock to when they tire of the beach! Offering 200 total units, the North Tower Oceanfront unit mix includes 90 oceanfront studios with private balcony, mini-refrigerator and microwave (Floor Plan A) and 90 oceanfront studios with private balcony and an efficiency kitchen (Floor Plan B). On the southern corner of the building there are 10 oceanfront parlors (Floor Plan F) and 3 oceanfront parlor suites (Floor Plan G) that feature a private oceanfront balcony as well as a side ocean view balcony.

On the top two floors, the interior space was redesigned to provide more expansive units. There are three oceanfront junior executive suites (Floor Plan H), four oceanfront executive suites with Jacuzzi (Floor Plan I) and one 3-room suite (floor Plan B/I). When released to condominium sales, the response was immediate with the inventory sold out in a few weeks. Owners remain extremely happy with their units but there usually a few listed on the resale market. Call The Hoffman Group today to find out how you can become a proud owner in this special resort.

sales & marketing by:

thehoffmangroup
OCEANFRONT PROPERTY SPECIALISTS

toll free: 800-458-7890

local: 843-390-8900

www.oceaninvestments.com

All renderings, maps, landscaping, elevations, and plans are artist's conceptions. They are not to scale and are not guaranteed. The developer/builder reserves the right in its sole discretion to make changes or modifications to maps, plans, specifications, materials, features and colors without notice.



sales & marketing by:

the hoffmann group
OCEANFRONT PROPERTY SPECIALISTS

toll free: 800-458-7890

local: 843-390-8900

www.oceaninvestments.com

All renderings, maps, landscaping, elevations, and plans are artist's conceptions. They are not to scale and are not guaranteed. The developer/builder reserves the right in its sole discretion to make changes or modifications to maps, plans, specifications, materials, features and colors without notice.

Ocean Reef

UNIT A

Oceanfront
2 Queen Beds
Private Balcony
Refrigerator
Microwave

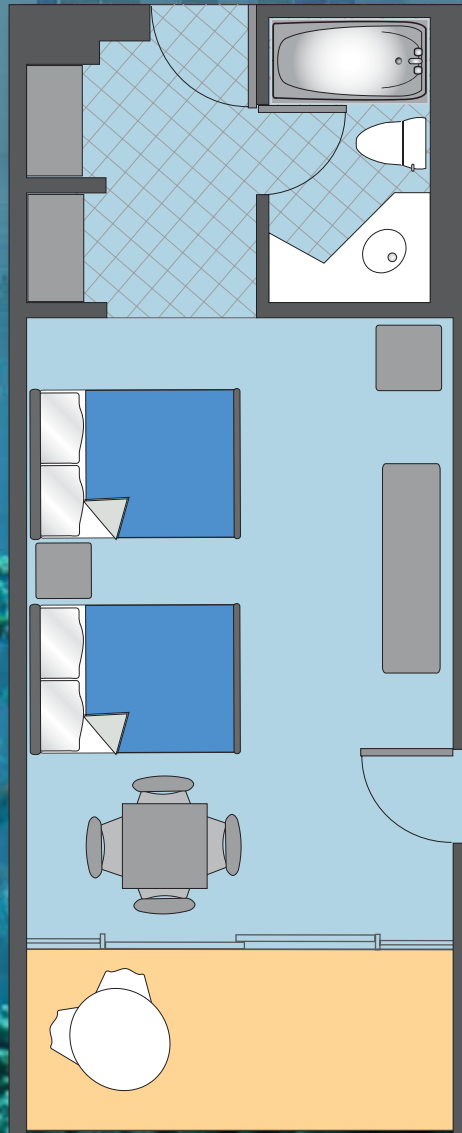

sales & marketing by:

thehoffmangroup
OCEANFRONT PROPERTY SPECIALISTS

toll free: 800-458-7890

local: 843-390-8900

www.oceaninvestments.com

All renderings, maps, landscaping, elevations, and plans are artist's conceptions. They are not to scale and are not guaranteed. The developer/builder reserves the right in its sole discretion to make changes or modifications to maps, plans, specifications, materials, features and colors without notice.

Ocean Reef

UNIT B

Oceanfront
2 Queen Beds
Private Balcony
Kitchenette
Kitchenette
Microwave

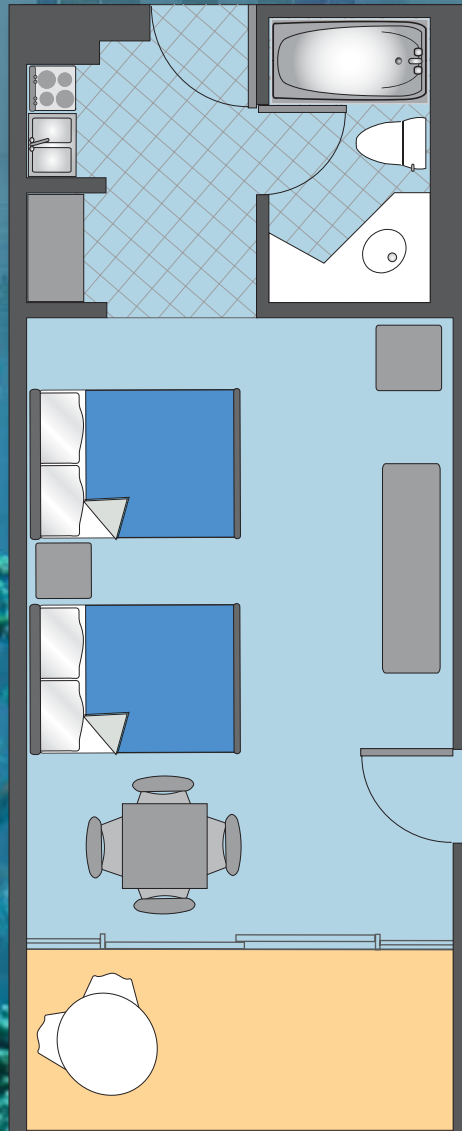

sales & marketing by:

thehoffmangroup
OCEANFRONT PROPERTY SPECIALISTS

toll free: 800-458-7890

local: 843-390-8900

www.oceaninvestments.com

All renderings, maps, landscaping, elevations, and plans are artist's conceptions. They are not to scale and are not guaranteed. The developer/builder reserves the right in its sole discretion to make changes or modifications to maps, plans, specifications, materials, features and colors without notice.

Ocean Reef

UNIT FQ or FK

Oceanfront Bedroom
with 2 Queen Beds or 1 King
Private Double Oceanfront Balcony
Oceanview Balcony
Kitchenette



sales & marketing by:

the hoffmann group
OCEANFRONT PROPERTY SPECIALISTS

toll free: 800-458-7890

local: 843-390-8900

www.oceaninvestments.com

All renderings, maps, landscaping, elevations, and plans are artist's conceptions. They are not to scale and are not guaranteed. The developer/builder reserves the right in its sole discretion to make changes or modifications to maps, plans, specifications, materials, features and colors without notice.

Ocean Reef

UNIT G

Oceanfront Bedroom w/1 King Bed
Separate Sitting Area w/ Murphy Bed
Private Double Oceanfront Balcony
Oceanview Balcony
Kitchenette

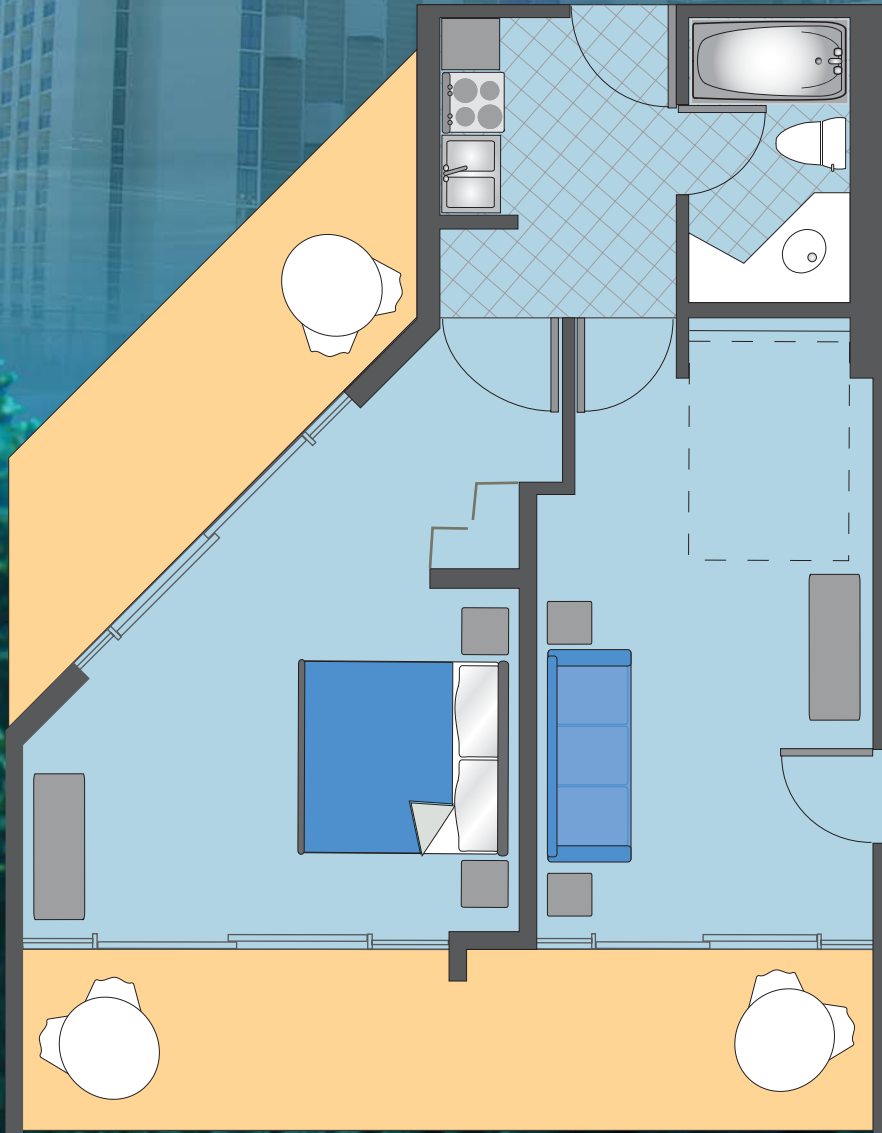

sales & marketing by:

thehoffmangroup
OCEANFRONT PROPERTY SPECIALISTS

toll free: 800-458-7890

local: 843-390-8900

www.oceaninvestments.com

All renderings, maps, landscaping, elevations, and plans are artist's conceptions. They are not to scale and are not guaranteed. The developer/builder reserves the right in its sole discretion to make changes or modifications to maps, plans, specifications, materials, features and colors without notice.

Ocean Reef

UNIT H -16th floor

Oceanfront Junior Executive Suite
Private Double Oceanfront Balcony
Separate Sitting Area w/ Murphy Bed
1 Bedroom; 2 baths
Kitchenette

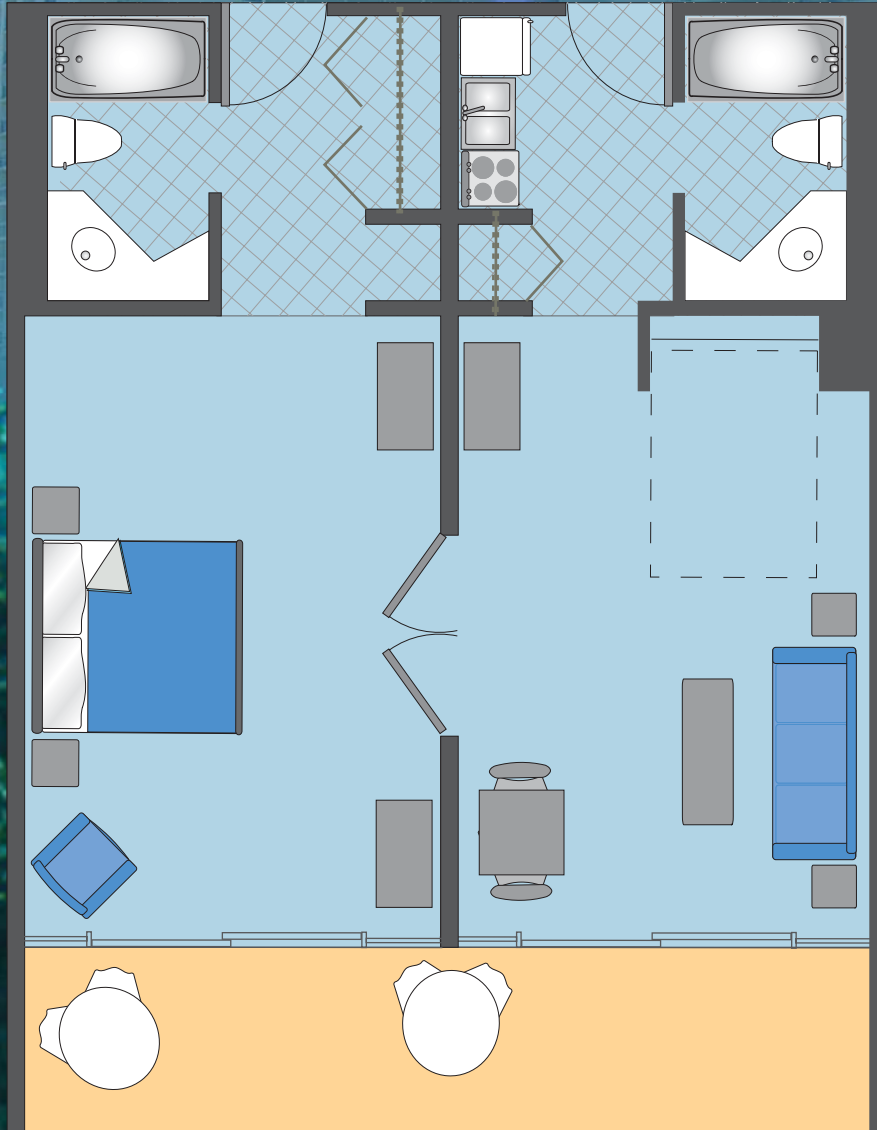

sales & marketing by:

thehoffmangroup
OCEANFRONT PROPERTY SPECIALISTS

toll free: 800-458-7890

local: 843-390-8900

www.oceaninvestments.com

All renderings, maps, landscaping, elevations, and plans are artist's conceptions. They are not to scale and are not guaranteed. The developer/builder reserves the right in its sole discretion to make changes or modifications to maps, plans, specifications, materials, features and colors without notice.

Ocean Reef

UNIT I -17th floor

Oceanfront Executive Suite
Private Double Oceanfront Balcony
Living area with sleeper sofa
Bedroom, Bath with whirlpool tub
Kitchenette

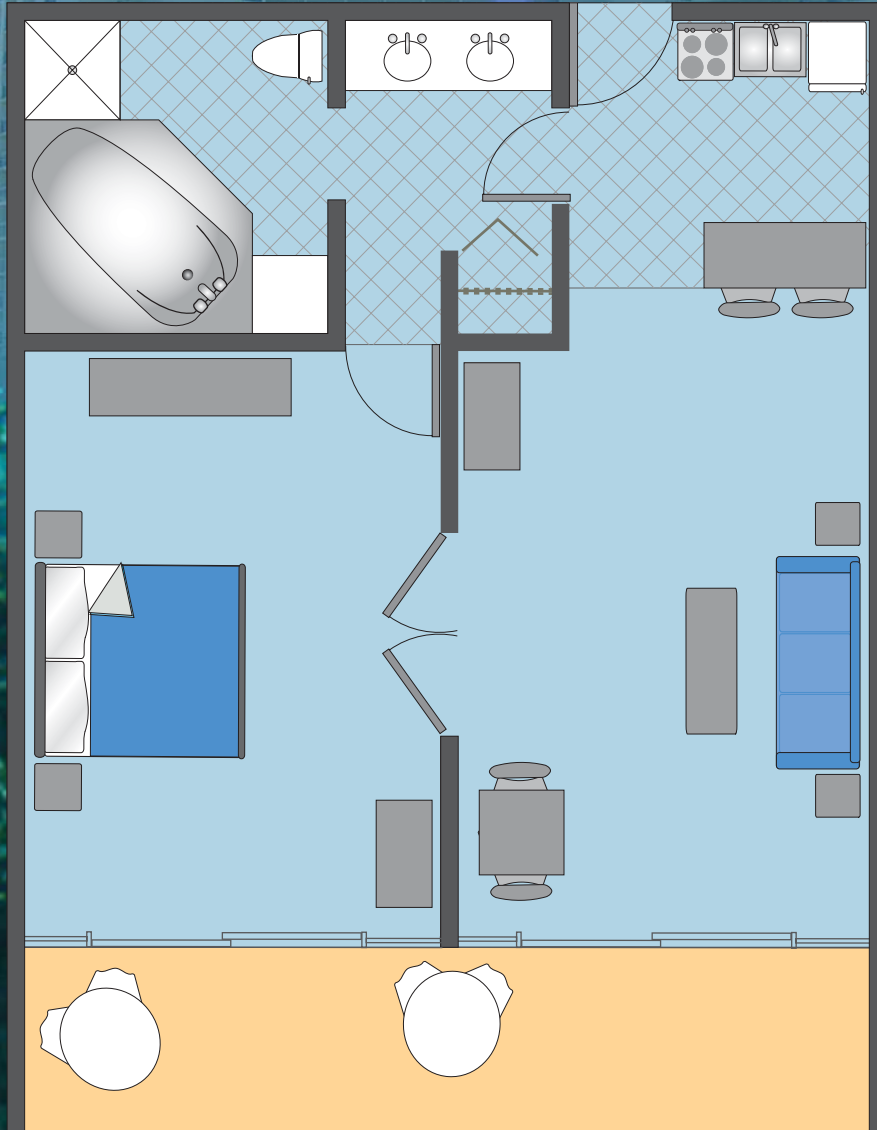

sales & marketing by:

thehoffmangroup
OCEANFRONT PROPERTY SPECIALISTS

toll free: 800-458-7890

local: 843-390-8900

www.oceaninvestments.com

All renderings, maps, landscaping, elevations, and plans are artist's conceptions. They are not to scale and are not guaranteed. The developer/builder reserves the right in its sole discretion to make changes or modifications to maps, plans, specifications, materials, features and colors without notice.